

# ISOLUTE<sup>®</sup> PLD+ Protein and Phospholipid Removal Products

---

Simple, Effective Sample Clean up for LC-MS/MS

# ISOLUTE® PLD+

Effortlessly Improve Analyte Sensitivity

## ISOLUTE® PLD+

### Protein and Phospholipid Removal Columns and Plates

ISOLUTE® PLD+ Protein and Phospholipid Removal products provide a very effective but extremely simple sample clean up for blood based samples prior to LC-MS/MS analysis. Requiring next to no method development, ISOLUTE PLD+ can be integrated quickly and easily into routine workflow, increasing productivity and reducing instrument downtime. ISOLUTE PLD+ products remove >99 % of plasma proteins and phospholipids, the main causes of ion suppression, leading to cleaner extracts and increased sensitivity (signal-to-noise (S/N)) for a broad range of analytes.

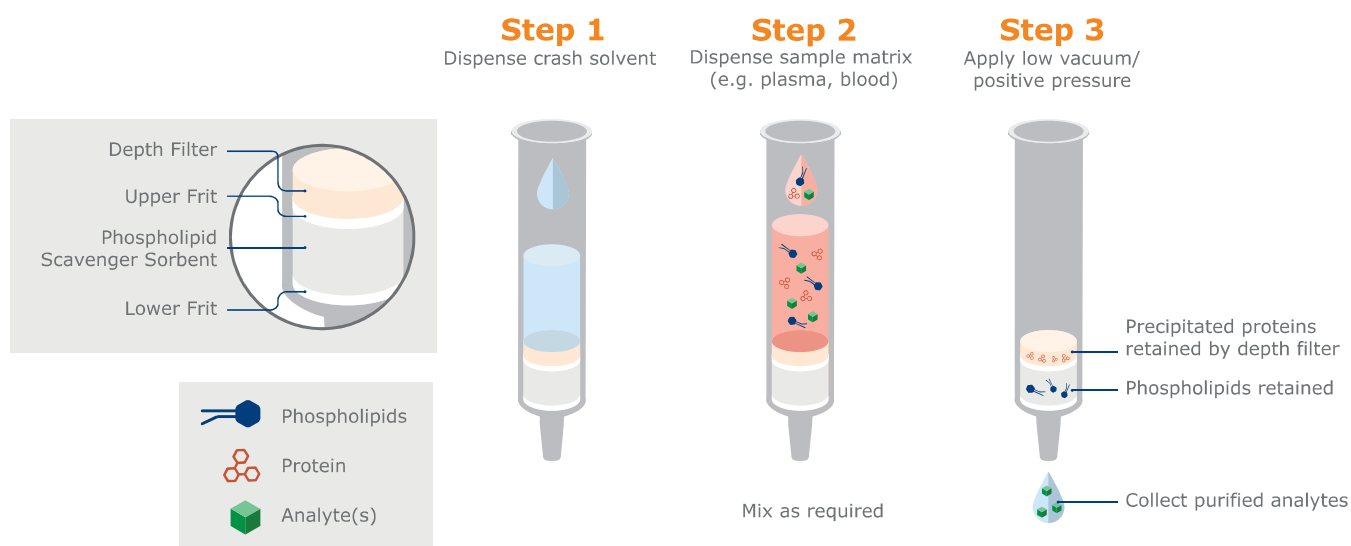

Typical ISOLUTE® PLD+ procedure.

Using a simple solvent crash/filtration based procedure, proteins and phospholipids are simultaneously removed from plasma and other blood based samples while high, reproducible analyte recoveries are maintained. The optimized frit arrangement acts as a depth filter, efficiently trapping precipitated proteins, without blocking or plugging.

ISOLUTE PLD+ plates and columns can be processed using positive pressure or vacuum processing systems – see page 60 for ordering information.

### ISOLUTE PLD+ Protein and Phospholipid Removal Products

Part Number	Description	Qty.
918-0050-P01	ISOLUTE PLD+ Protein and Phospholipid Removal Plate	1
918-0005-AG	ISOLUTE PLD+ Protein and Phospholipid Columns 50 mg/1 mL (tablets)	100

### Accessories

Part Number	Description	Qty.
121-5202	Collection plate, 1 mL, square	50
121-5203	Collection plate, 2 mL, square	50
121-5213	Collection plate, 2 mL, round	50

For more information, visit [www.biotage.com](http://www.biotage.com)